

RUOTE

I Ruote in C45 normali a 1 cuscinetto - gola V

- UK Normal wheel with one bearing - V groove
- D Laufrollen mit einem Lager - V Nut
- F Roues normales avec 1 roulement - gorge V
- E Ruedas normales con 1 cojinete - guía V
- RUS Ролик нормальный с 1 подшипником паз V

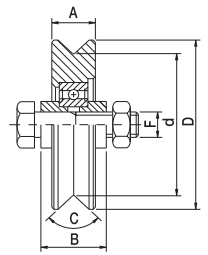

Compatibile con

ANGULA



Articolo - Article		D	d	A	B	C	F	LxHxS	Portata Capacity		
Riferimento - Reference		∅		mm		V	UNI	mm	kg x1	N°	kg
518 V	RT 50 18 V1	50	39	18	24	96°	M 10x45	50x30x3	60	30	7,2
618 V	RT 60 18 V1	60	49	18	24	96°	M 10x45	60x30x3	80	30	10,2
718 V	RT 70 18 V1	70	59	18	24	96°	M 10x45	60x30x3	100	20	10
820 V	RT 80 20 V1	80	65	20	24	96°	M 12x50	80x30x3	140	20	13
920 V	RT 90 20 V1	90	75	20	24	96°	M 12x50	80x30x3	160	20	17
1020 V	RT 10 20 V1	100	85	20	34	96°	M 14x60	100x40x3	180	20	22,4
1220 V	RT 12 20 V1	120	105	20	34	96°	M 14x60	120x40x3	200	12	19,6
1420 V	RT 14 20 V1	140	125	20	34	96°	M 14x60	120x40x3	230	6	13,5
1620 V	RT 16 20 V1	160	145	20	34	96°	M 14x60	140x40x3	250	6	17,6

I Ruote in C45 normali a 1 cuscinetto - gola U

- UK Normal wheel with one bearing - U groove
- D Laufrollen mit einem Lager - U Nut
- F Roues normales avec 1 roulement - gorge U
- E Ruedas normales con 1 cojinete - guía U
- RUS Ролик нормальный с 1 подшипником паз U

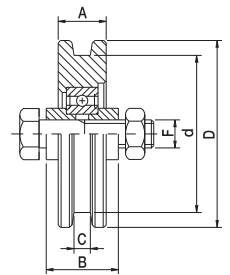

Articolo - Article		D	d	A	B	C	F	LxHxS	Portata Capacity		
Riferimento - Reference		∅		mm		U	UNI	mm	kg x1	N°	kg
618 U	RT 60 18 U1	60	49	18	24	7	M 10x45	60x30x3	80	30	10,2
718 U	RT 70 18 U1	70	59	18	24	7	M 10x45	60x30x3	100	20	10
820 U	RT 80 20 U1	80	65	20	24	7	M 12x50	80x30x3	100	20	12
920 U	RT 90 20 U1	90	75	20	24	7	M 12x50	80x30x3	160	20	16,5
1020 U	RT 10 20 U1	100	85	20	34	7	M 14x60	100x40x3	180	20	22,1
1220 U	RT 12 20 U1	120	105	20	34	7	M 14x60	120x40x3	200	12	19,1
1420 U	RT 14 20 U1	140	125	20	34	7	M 14x60	120x40x3	230	6	13,1
1620 U	RT 16 20 U1	160	145	20	34	7	M 14x60	140x40x3	250	6	17,7

I Ruote in C45 normali a 1 cuscinetto - gola O

- UK Normal wheel with one bearing - O groove
- D Laufrollen mit einem Lager - O Nut
- F Roues normales avec 1 roulement - gorge O
- E Ruedas normales con 1 cojinete - guía O
- RUS Ролик нормальный с 1 подшипником паз O

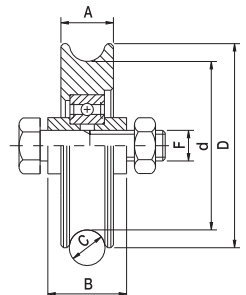

Compatibile con

NEWOMEGA

NEWOMEGA2

FLOOR

HEAVY

IBBI

SISTEMA

Articolo - Article		D	d	A	B	C	F	LxHxS	Portata Capacity		
Riferimento - Reference		∅		mm		O	UNI	mm	kg x1	N°	kg
827 O	RT 80 27 O1	80	61	26	34	21	M 14x60	80x40x3	140	20	15
1027 O	RT 10 27 O1	100	81	26	34	21	M 14x60	100x40x3	180	16	20,6
1227 O	RT 12 27 O1	120	101	26	34	21	M 14x60	120x40x3	200	10	19,3